



AWWA

BUTTERFLY VALVE

*Over 60 years world leading manufacturer
of high quality valves and actuators...*

AFFCO

Company Info

AFFCO General

Valves play a pivotal role in a multitude of industries to provide flow control in pipelines. Seeing the significance of valves across multiple industries, AFFCO embarked on a journey to manufacture high quality, high performance butterfly valves.

AFFCO pledges to build up an ever stronger research and development capability, further improve its product quality and design, and provide better customer service, to achieve their goals of being a globally renowned manufacturer of butterfly valves, valves and flow control systems.

AFFCO focus on three key aspects, quality, precision and service.



Innovation

AFFCO insists in NPD every year to breakthrough the existing problems and create more value to customers.



Sustainability

AFFCO advocates sustainable development in products concept to build eco system.



Reliability

AFFCO has stable operation torque, the sealing performance remains stable with temperature changes and long life time.



R&D Capabilities

AFFCO's research laboratory is a key element in maintaining company's technological lead in all of its core products. Research activities, which are optimized using state of the art methods and performed by highly qualified personnel are divided into:

- Project driven development according to customer requirements and applications.
- Technology driven development of new products through Innovation.

Manufacturing Capabilities

AFFCO Range of products are manufactured in accordance with ISO 9001 quality management system and designed and tested according to API, EN & JIS standards with long life time and low maintenance.

Stock Service

AFFCO invested heavily in ERP system to effectively manage our huge material stock and quickly response for customer delivery demands.

Why Choose AFFCO

■ Double Eccentric Design

The stem of disc rotation is horizontally and vertically offset from the body seat. This high performance design eliminates the friction and compression between disc and seat while the valve is in the open position. Compression on the seal is released after only a few degrees of opening.

■ High Working Pressure

ASTM A536 65-45-12 Ductile Iron body and patent seat construction make the valve suitable for pressure from vacuum to 40 bar.

■ Drinking Water Safe

WRAS approved rubber and NSF 61 approved coating for use in potable water systems.

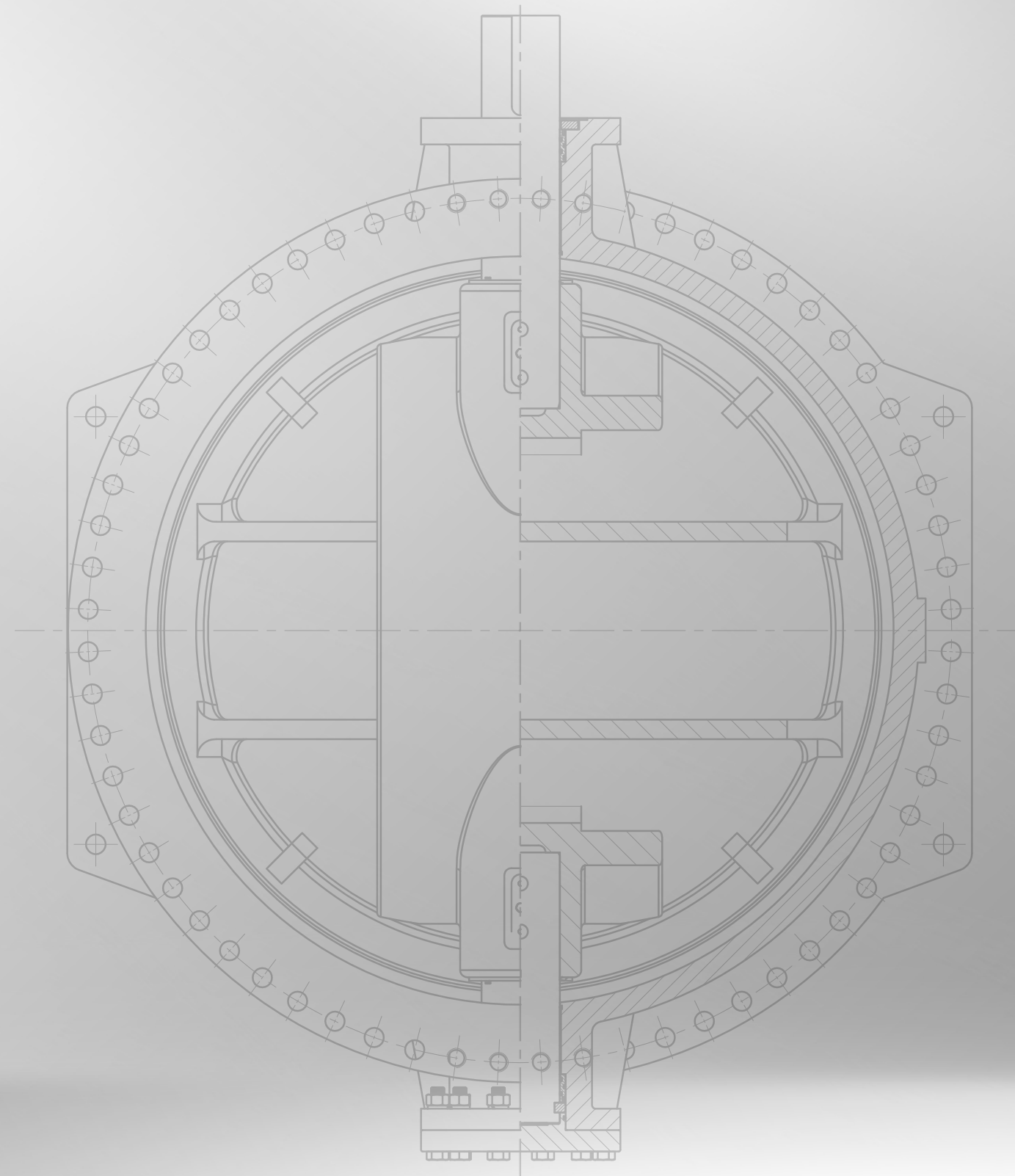

■ Dry Shaft Design

Full AWWA C504/C516 diameter stub shafts remain dry through multiple O-ring seals on both the upper and lower shafts. This prevents corrosion inside the stem hole and avoids shaft clogging.

■ Certified Zero Leakage

AFFCO valve is tested in accordance with AWWA C504/C516, test certificate for each valve is included. The certificate includes a leak test report, torque test record, and heat number trace of the valve components.

■ Ease of Maintenance

The valve design requires zero to minimal maintenance. Seal ring replacement can be achieved without dismantling other parts of the valve except seal ring retainer.

■ Actuator inversion

The upper flange is equivalent to lower flange. The actuator can be discharged and be installed to lower flange when it is required.

Mechanical Construction

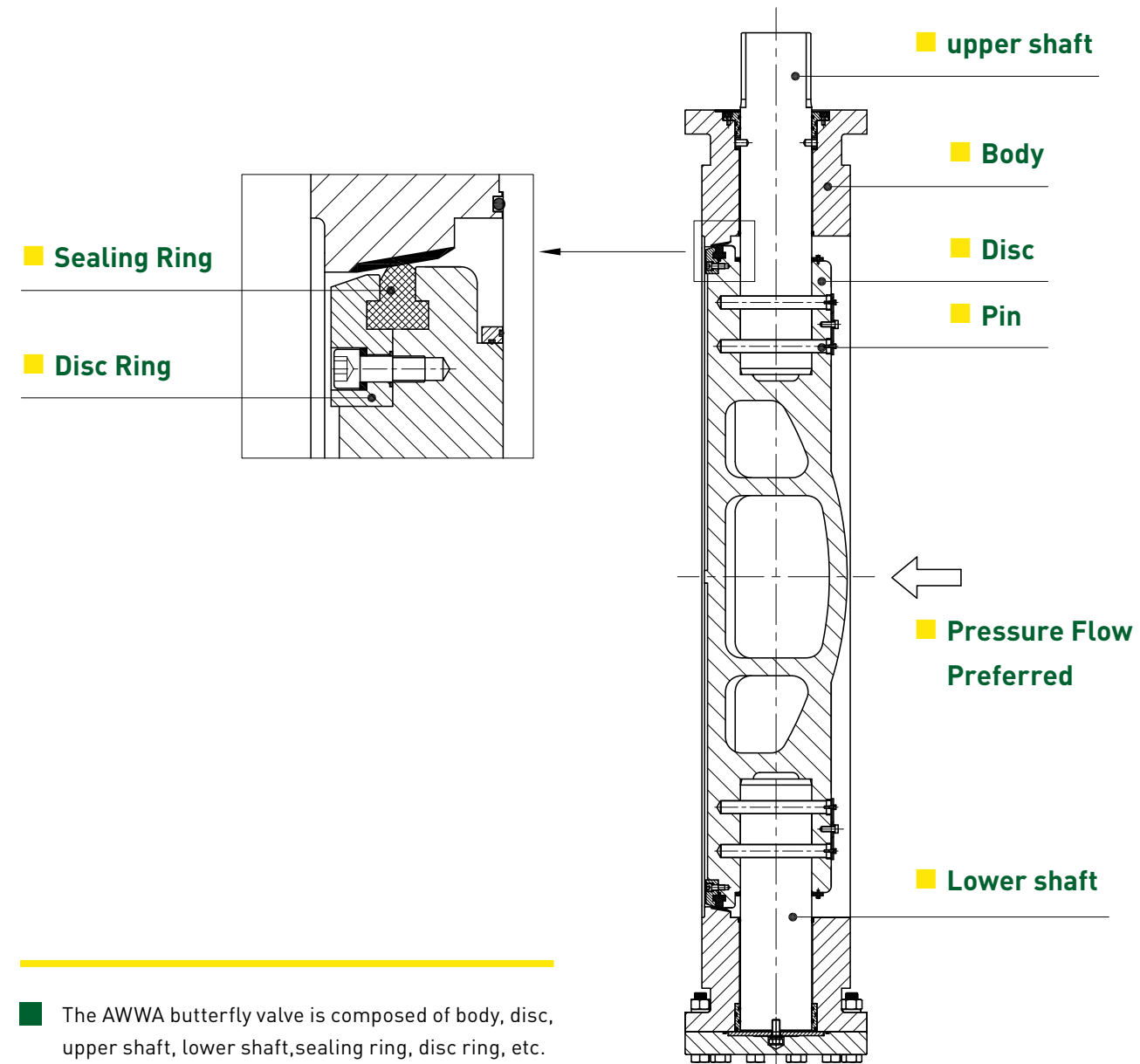

■ The AWWA butterfly valve is composed of body, disc, upper shaft, lower shaft, sealing ring, disc ring, etc. The materials are according to AWWA standard.

■ The disc is designed as low flow resistance. It can resistance cavitation.

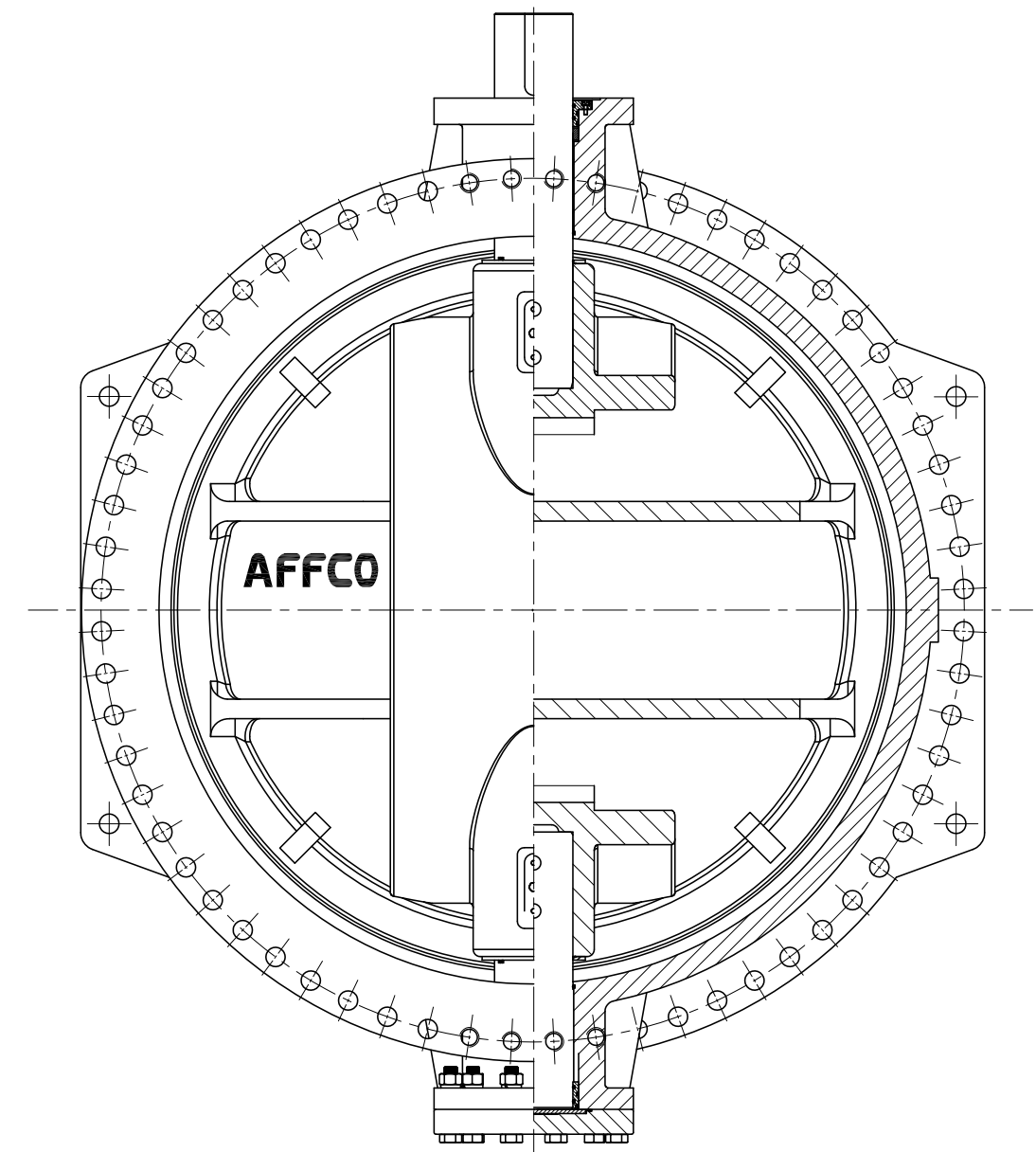

■ Application

- Water distribution main isolation valve, suitable for above ground and buried service

■ Features

- Double Eccentric and twin shaft design for maximum flow
- Material: 316 stainless steel seat
- Heavy duty design, ductile iron construction with WRAS fusion bonded epoxy

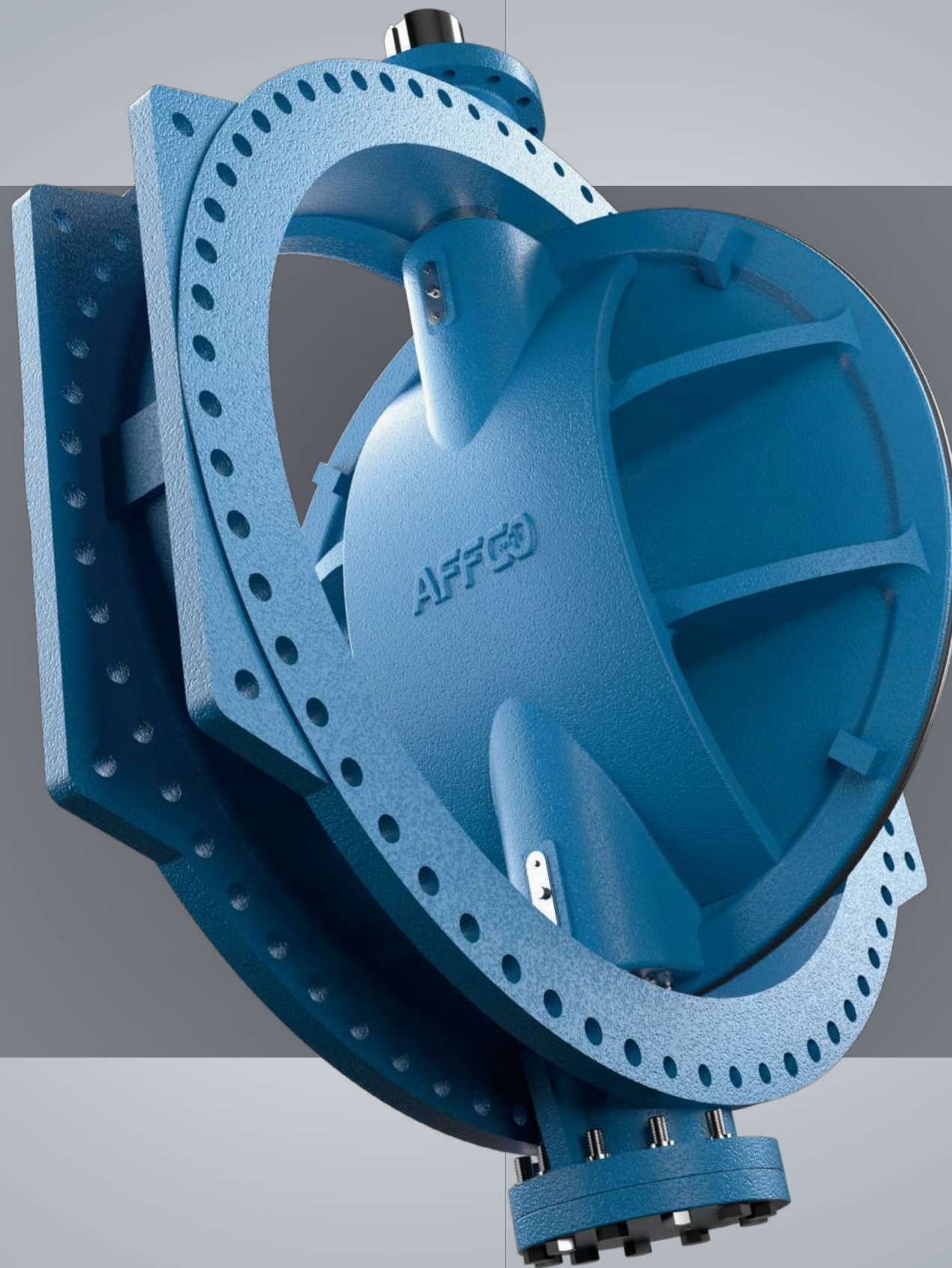

■ Options

- Alternative flange drilling PN10, PN16, PN25, BST D/E connections
- Anti-clockwise closing
- Buried service gearbox
- Larger sizes on request
- Various seat materials

■ Accessories

- Position indication, limit switches, locking facility, chain wheel assemblies, extension spindles, floor pillar

Design Feature

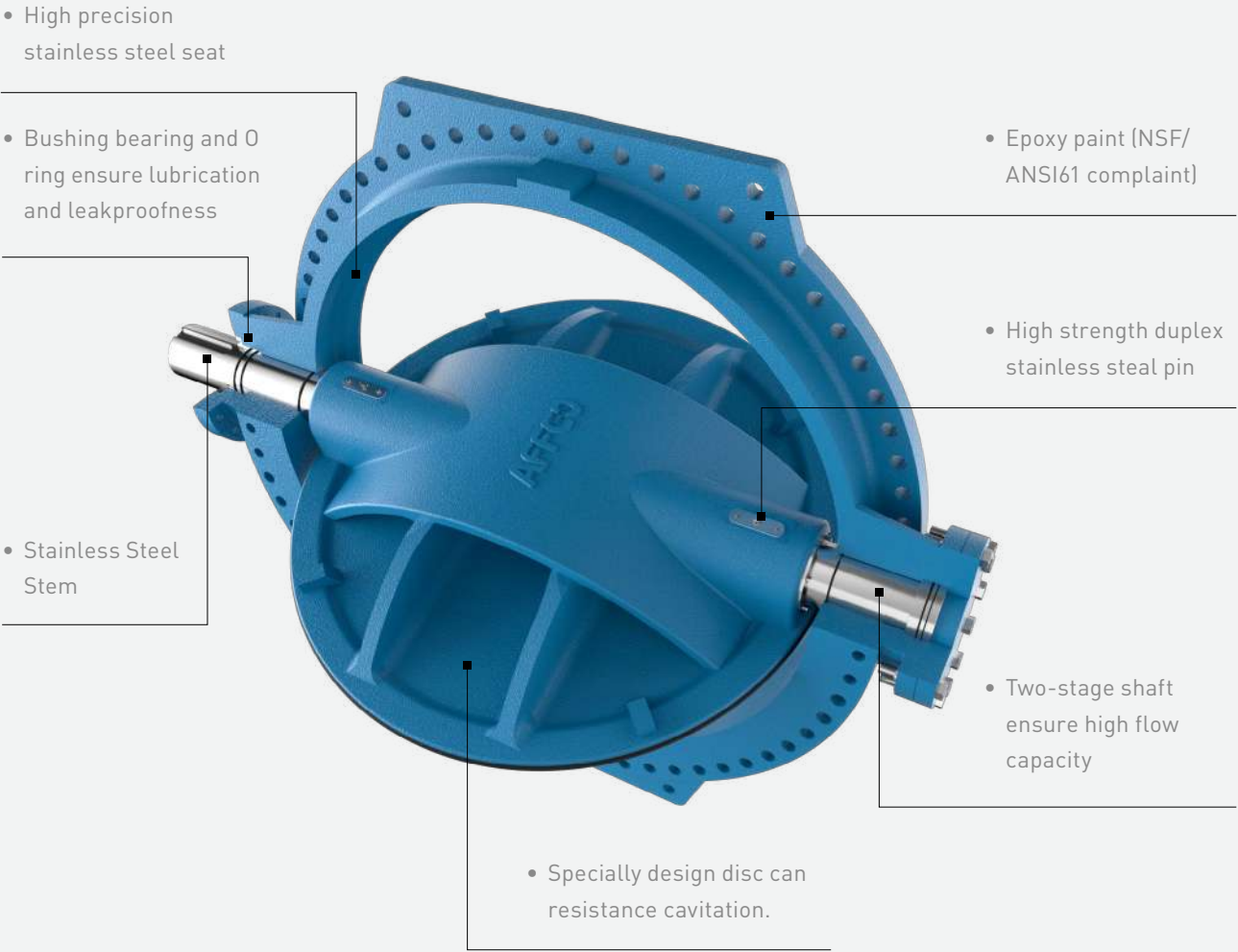

Material & Configuration

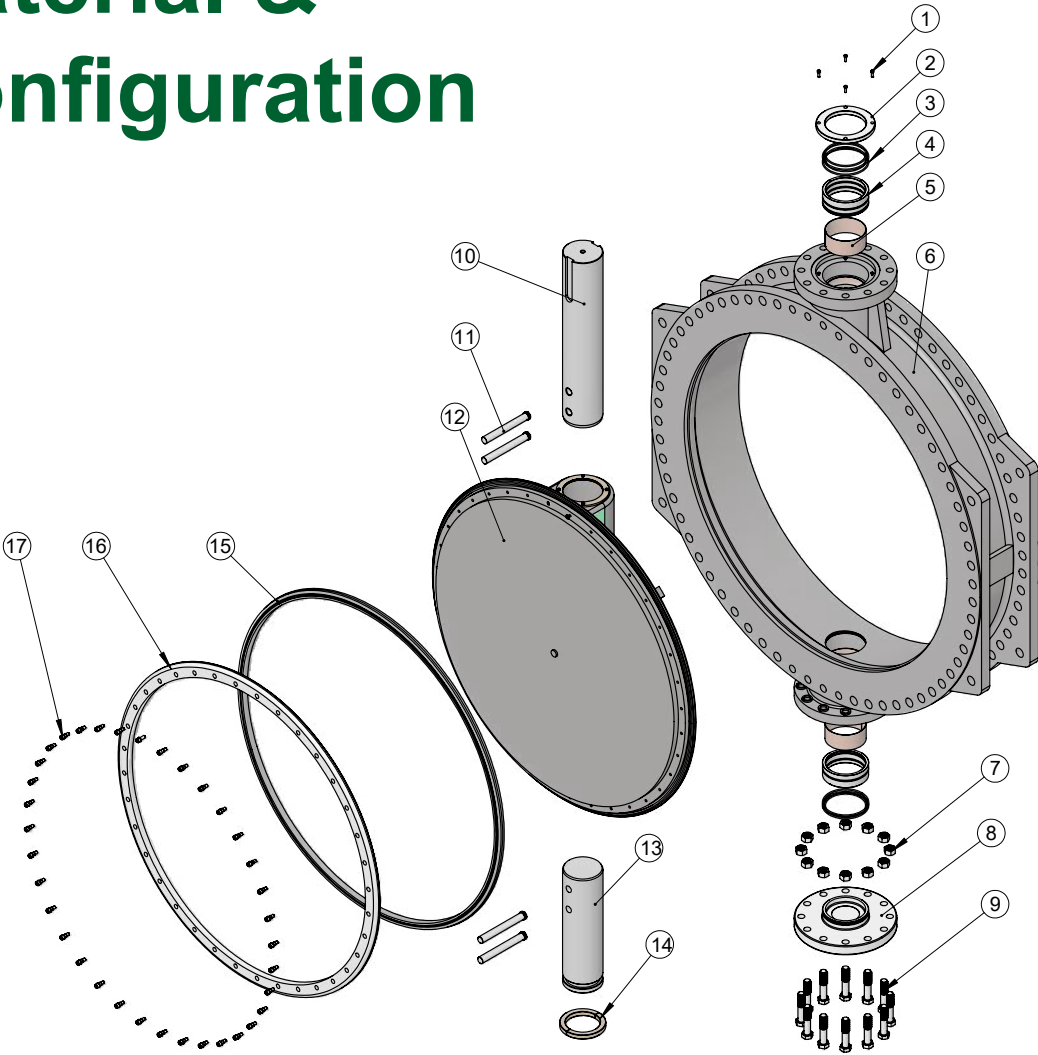

Material List

NO.	NAME	MATERIAL	NO.	NAME	MATERIAL
1	scrow	B7/B8/B8M	10	upper shaft	F51/F304/17-4PH
2	press plate	304/316/C95800/C83600	11	pin	F51/F304/17-4PH
3	O-Ring	NBR/EPDM/VITON	12	disc	ASTM A536 / ASTM A536+Rubber
4	stuffing box	C95800/C83600	13	lower shaft	F51/F304/17-4PH
5	bushing bearing	316 with PTFE	14	half plate	C95800/C83600
6	body	ASTM A536 / ASTM A536+Rubber	15	sealing ring	NBR/EPDM/VITON
7	nut	B7/B8/B8M	16	disc ring	304/316
8	cover	ASTM A536	17	scrow	B7/B8/B8M
9	bolt	B7/B8/B8M			

Double Eccentric Butterfly Valve

Series S953



Flange Connection Standard	AWWA C207
Design And Test Standard	AWWA C504/C516
Face to Face Standard	AWWA C504/C516
Top Flange	ISO 5211
Service Medium	Water

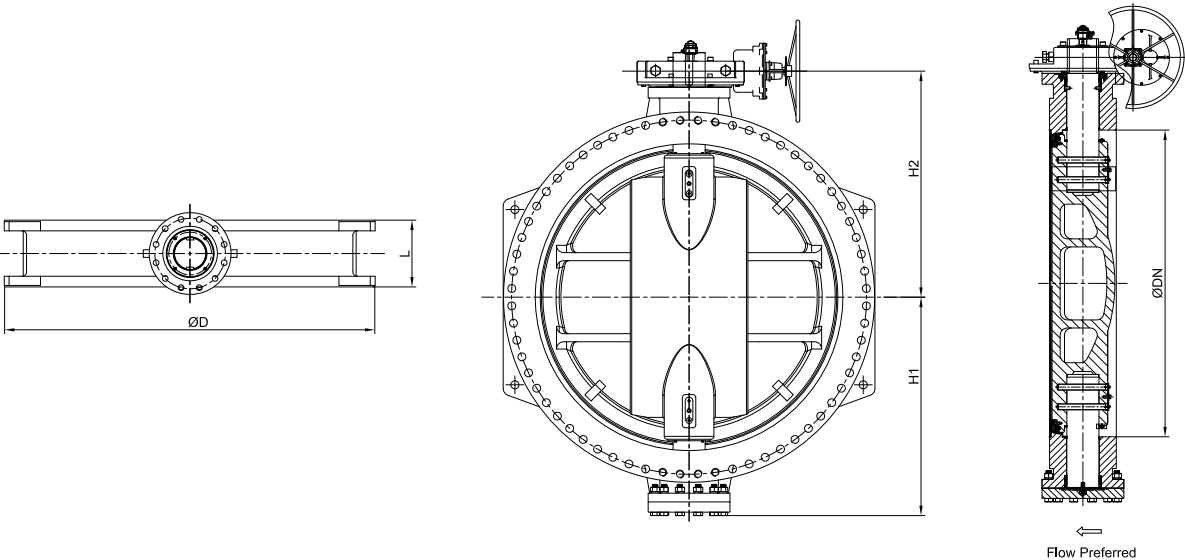

Dimensions

CL150B

SIZE		L	D	DN	H1	H2
NPS	DN	mm	mm	mm	mm	mm
6"	150	127	279.4	150	156	218
8"	200	152	342.9	200	193	265
10"	250	203	406.4	250	223	300
12"	300	203	482.6	300	252	330
14"	350	203	533.4	350	296	381
16"	400	203	596.9	400	396	411
18"	450	203	635.0	450	430	441
20	500	203	698.5	500	445	482
24"	600	203	812.8	600	515	544
36"	900	305	1168.4	900	702	811
42	1050	305	1346.2	1050	851	950
48	1200	381	1511.3	1200	943	1058
60	1500	381	1854.2	1500	1135	1326
72	1800	457	2197.1	1800	1320	1594
84	2100	457	2533.7	2100	1465	1720
96	2400	533	2876.6	2400	1620	2095

Double Eccentric Butterfly Valve

Series S954



Flange Connection Standard	EN1092-2(DN700-2000) DIN2501(DN>2000)
Design And Test Standard	EN593
Face to Face Standard	EN558
Top Flange	ISO 5211
Service Medium	Water

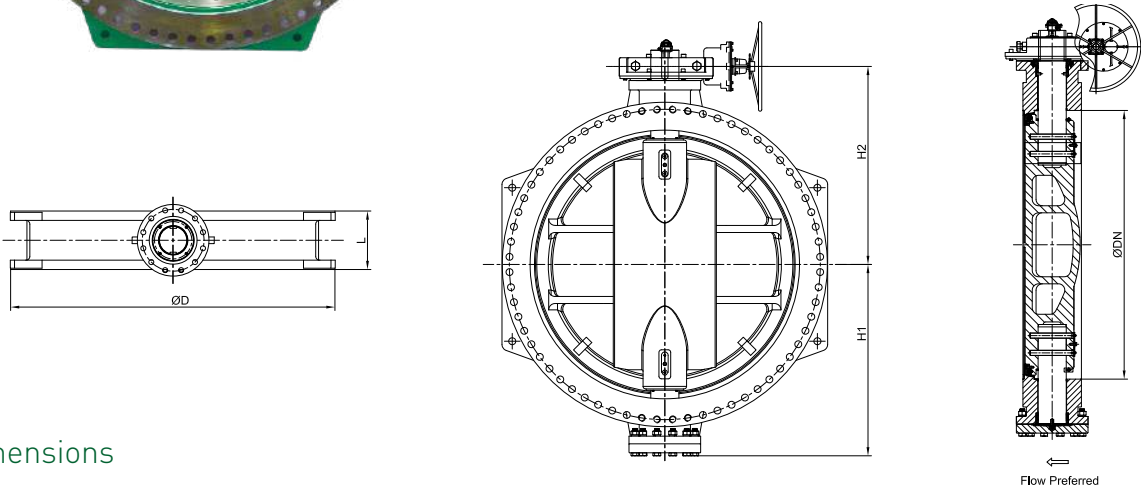

Dimensions

PN10

SIZE		L mm		D	DN	H1	H2
NPS	DN	F13	F14	mm	mm	mm	mm
6"	150	140	210	265	150	156	218
8"	200	152	230	340	200	193	265
10"	250	165	250	395	250	223	300
12"	300	178	270	445	300	252	330
14"	350	190	290	505	350	296	381
16"	400	216	310	565	400	320	411
18"	450	222	330	615	450	354	441
20	500	229	350	670	500	385	482
24"	600	267	390	780	600	465	544
28"	700	292	430	895	700	530	610
36"	900	330	510	1115	900	640	811
40	1000	410	550	1230	1000	710	932
48	1200	470	630	1455	1200	845	1058
56	1400	530	710	1675	1400	976	1251
60	1500	570	750	1785	1500	1035	1326
64	1600	600	790	1915	1600	1135	1424
72	1800	670	870	2115	1800	1203	1594
80	2000	760	950	2325	2000	1340	1715
88	2200	800	1030	2550	2200	1418	1850
96	2400	850	1110	2760	2400	1595	2095
104	2600	900	1190	2960	2600	1760	2280
112	2800	950	1270	3180	2800	1910	2420
120	3000	1000	1350	3405	3000	2040	2550

PN16

SIZE		L mm		D	DN	H1	H2
NPS	DN	F13	F14	mm	mm	mm	mm
6"	150	140	210	285	150	156	218
8"	200	152	230	340	200	193	265
10"	250	165	250	405	250	223	300
12"	300	178	270	460	300	252	330
14"	350	190	290	520	350	296	381
16"	400	216	310	580	400	320	411
18"	450	222	330	640	450	354	441
20	500	229	350	715	500	385	482
24"	600	267	390	840	600	465	544
28"	700	292	430	910	700	530	610
32"	800	318	470	1025	800	570	659
36"	900	330	510	1125	900	640	811
40	1000	410	550	1255	1000	710	932
48	1200	470	630	1485	1200	845	1058
56	1400	530	710	1685	1400	976	1251
60	1500	570	750	1820	1500	1035	1326
64	1600	600	790	1930	1600	1135	1424
72	1800	670	870	2130	1800	1203	1594
80	2000	760	950	2345	2000	1340	1715

PN25

SIZE		L mm		D	DN	H1	H2	H2
NPS	DN	F13	F14	mm	mm	mm	mm	mm
6"	150	140	210	300	150	162	225	225
8"	200	152	230	360	200	203	275	275
10"	250	165	250	425	250	233	310	310
12"	300	178	270	485	300	265	343	343
14"	350	190	290	555	350	310	396	396
16"	400	216	310	620	400	340	432	432
18"	450	222	330	670	450	369	456	456
20	500	229	350	730	500	392	490	490
24"	600	267	390	845	600	465	544	544
28"	700	292	430	960	700	555	635	635
32"	800	318	470	1085	800	600	690	690
36"	900	330	510	1185	900	670	840	840
40	1000	410	550	1320	1000	740	965	965
48	1200	470	630	1530	1200	865	1085	1085
56	1400	530	710	1755	1400	1010	1285	1285
60	1500	570	750	1865	1500	1065	1350	1350
64	1600	600	790	1975	1600	1160	1450	1450
72	1800	670	870	2195	1800	1240	1625	1625
80	2000	760	950	2425	2000	1380	1755	1755

PN40

SIZE		L mm		D	DN	H1	H2
NPS	DN	F13	F14	mm	mm	mm	mm
6"	150	140	210	300	150	262	275
8"	200	152	230	375	200	303	325
10"	250	165	250	450	250	333	360
12"	300	178	270	515	300	365	393
14"	350	190	290	580	350	410	446
16"	400	216	310	660	400	440	482
18"	450	222	330	685	450	469	506
20"	500	229	350	755	500	492	540
24"	600	267	390	890	600	565	594
28"	700	292	430	995	700	655	685
32"	800	318	470	1140	800	700	740
36"	900	330	510	1250	900	770	890
40"	1000	410	550	1360	1000	840	1015
48"	1200	470	630	1575	1200	980	1135
56"	1400	530	710	1795	1400	1110	1335
64"	1600	600	790	2025	1600	1260	1500

Certificates



Notes

**Website**

www.affco-flowcontrol.com

AFFCO Flow Control (Shanghai) Co., Ltd

No. 99 Desheng Road, Economic and Technological
Development Area, Feng Xian, Shanghai 201411

Tel: +86 (21) 5814 7016

Fax: +86 (21) 5814 7885

Email: sales@affco-flowcontrol.com

AFFCO Flow Control Europe B.V.

Opweg 90a

2871 NG Schoonhoven

The Netherlands

Tel: +31 (0) 85 877 27 56

Fax: +31 (0) 85 782 51 01

Email: europe@affco-flowcontrol.com

AFFCO Flow Control Pte Ltd

237, Pandan Loop, #05-04, Westech Building
Singapore 128424

Tel : +65 65709920

Fax : +65 65709923

Email: info@affco.com.sg

AFFCO Flow Control Mideast FZE

SAIF Suite Y-16 P.O. BOX 123612

Sharjah – U.A.E.

Tel: +971 6 5220879

Email: infoME@affco-flowcontrol.com

AFFCO Flow Control UK Ltd

Unit 7, Stafford Park 12, Telford,

Shropshire, TF3 3BJ, England

Tel : +44 (0)1952 459 338

Email: sales@affco-flowcontrol.co.uk